

**ITEM 36. TRAFFIC TREATMENT – FOOTWAY WIDENING – NICHOLSON
AND DOWLING STREETS WOOLLOOMOOLOO**

TRIM RECORD NO: 2015/256338

RECOMMENDATION

It is recommended that the Committee endorse the proposed footway widening at the intersection of Nicholson and Dowling Streets, Woolloomooloo.

DECISION

BACKGROUND

As part of the upgrade of Juanita Nielsen Community Centre in Woolloomooloo, the City received submissions from the local community to investigate traffic calming along Nicholson Street, Woolloomooloo near Dowling Street. The proposal is to increase the size of the existing footway widening at the intersection of Nicholson and Dowling Street, Woolloomooloo.

COMMENTS

The proposed traffic treatments will enhance the general appearance of the streetscape in Woolloomooloo, improve pedestrian safety and are part of the City's commitment to calm traffic and improve residential and community amenities.

The proposed kerb extensions will further reduce the distance a pedestrian needs to cross the road and lower vehicle speeds through the intersection. The proposed changes will not have any significant impact on traffic flow and do not involve the removal of any parking.

CONSULTATION

Extensive community consultation has been completed on the Juanita Nielsen Community Centre Upgrade with local residents and businesses in the area. This consultation included information on the proposed modifications to Nicholson Street and pedestrian conditions.

At the Lord Mayor's community consultation session held on 12 April 2013, the proposed footway widening was presented to the community attending and displayed on consultation boards at the information session.

There was a public concern raised about traffic speed in the area and whether the increase in elderly and children in the area coming to the refurbished centre would lead

to an increase in potential vehicle/ pedestrian conflicts, particularly on Nicholson Street, the new location for the main entry to the community centre and Outside School Hours Care (OSHC).

The City also consulted local residents and businesses in the area as part of the Development Application for the Juanita Nielsen Community Centre upgrade including proposals for the public domain works. There were 473 letters sent out with no responses supporting the proposal and no responses opposing the proposal for the footway widening at the intersection of Nicholson and Dowling Street.

FINANCIAL

Funds are available in the current budget as part of the Juanita Nielsen Centre Upgrade.

ATTACHMENTS

Traffic Treatment – Footway Widening - Nicholson and Dowling Streets Woolloomooloo

Paula Yu, Project Manager, Buildings, City Projects and Property

LEGEND

	existing steel free to be retained - refer architect dwg
	new steel free to be retained - refer architect dwg
	existing asphalt pavement to be retained
	existing kerb - raised & adjusted
	concrete pavers 600 x 400mm
	in situ concrete paving - coloured
	recycled sandstone paving
	new pavers ramp
	new sandstone kerb
	new concrete gutter & new asphalt adjacent
	concrete edge adjacent building
	paver course adjacent building
	polyphth safety surface
	precast concrete stepping pad
	steel free pit with decomposed granite
	mass planting
	about with vines - refer architect dwg
	moveable timber stools
	bike racks
	metal gate - multi-panel - refer architect dwg
	fence - refer architect dwg
	linear slide - refer architect dwg
	waterplay
	existing levels
	proposed levels
	boundary
	street light

Existing kerb dashed

Proposed kerb

Existing kerb dashed

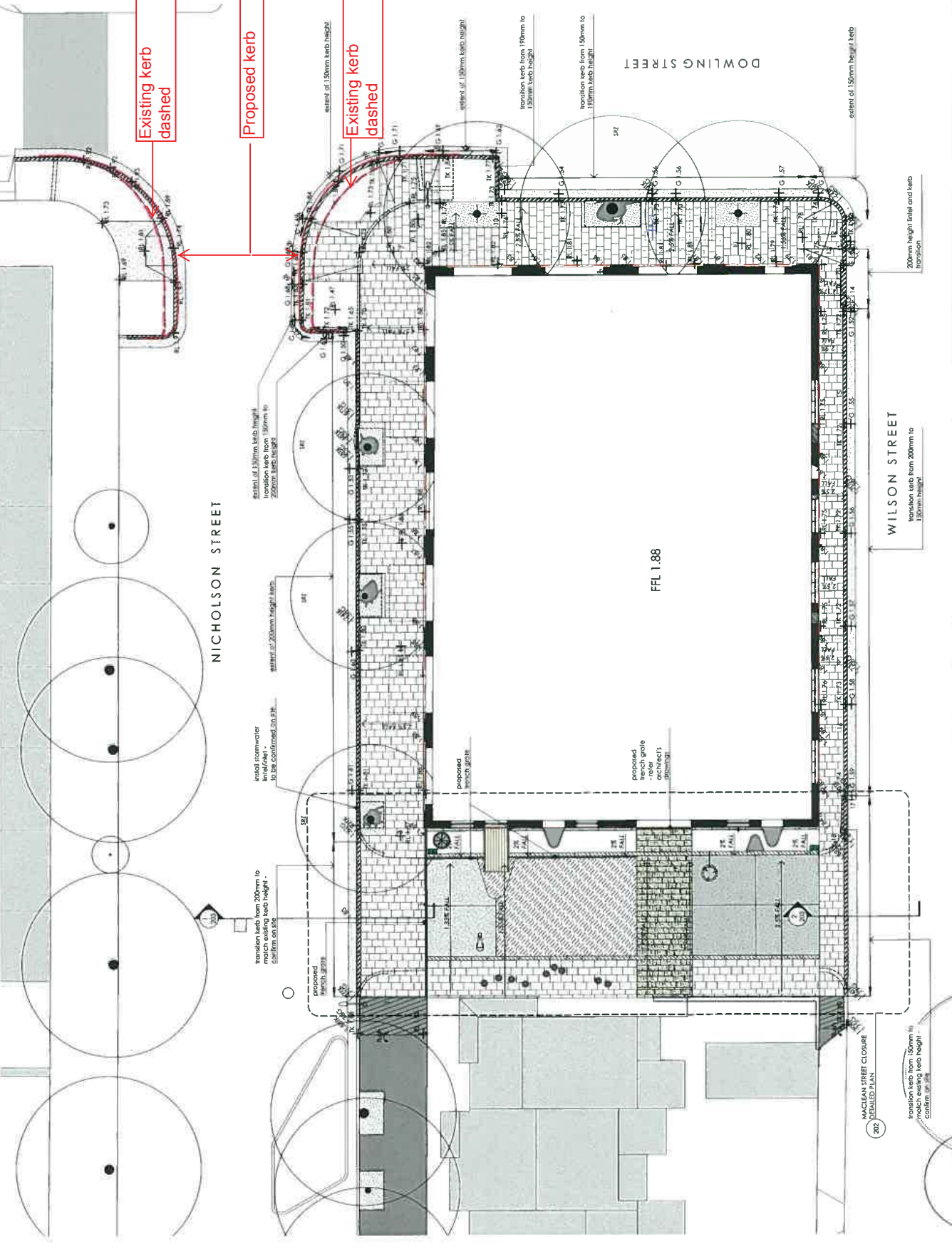

NOTES:

- DO NOT SCALE OFF DRAWINGS; FOLLOW WATER DIMENSIONS & FLOOR! OBTAIN WRITTEN ADVICE FROM THE SUPERINTENDENT.
- VERIFY ALL DIMENSIONS ON SITE.
- READ IN CONJUNCTION WITH THE SPECIFICATION.
- READ IN CONJUNCTION WITH ALL ARCHITECTURAL, CIVIL, STRUCTURAL, MECHANICAL AND ELECTRICAL ENGINEERS DRAWINGS AND SPECIFICATIONS.
- CONTRIBUTOR OF ALL SPACES ON SITE PRIOR TO ERECTION.
- READ AT A1.

CONTRACTORS:

City of Sydney

Project Name: JAMIA NELSIN CENTRE UPGRADE
Scale: 1:100 @ A1, 1:200 @ A3 + June 2013
Date: 25.05.18
Issue: Traffic committee submission
Author: JAMIA NELSIN CENTRE UPGRADE
Check: JAMIA NELSIN CENTRE UPGRADE
Drawn: JAMIA NELSIN CENTRE UPGRADE
Scale: 1:100 @ A1, 1:200 @ A3 + June 2013
Date: 25.05.18
Issue: Traffic committee submission
Author: JAMIA NELSIN CENTRE UPGRADE
Check: JAMIA NELSIN CENTRE UPGRADE
Drawn: JAMIA NELSIN CENTRE UPGRADE

